

Foodservice Equipment • Material Handling, Healthcare & Cleanroom Equipment • Retail Display

# Hangers and Hanger Bar Kits



closed loop hanger



open loop hanger



2-piece hanger

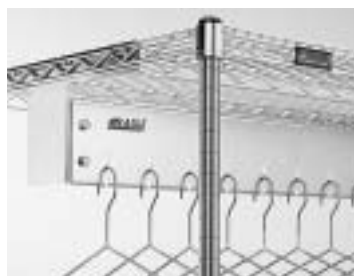

hanger bar kit

Item #:	_____
Model #:	_____
Project #:	_____
SIS #:	_____

Optional Accessories	Model #	Qty.

## Hangers

- ◆ For freestanding or wall mounted gowning racks, removable or non-removable models.
- ◆ Closed and open loop hangers available in chrome, stainless steel, or electropolished finish.
- ◆ 2-piece hanger available in stainless steel or electropolished finish.
- ◆ 2-piece hangers and closed loop hangers discourage removal from the gowning area.

## Hanger Bar Kits

- ◆ Converts wire shelving into freestanding or wall mounted gowning racks.
- ◆ Attaches to underside of wire shelf.
- ◆ For use with 2-piece hangers and open loop hangers only.
- ◆ 24" (610mm) shelf width only.

Spec sheets available for viewing, printing or downloading from our online literature library at [www.eaglegrp.com](http://www.eaglegrp.com)

## Hangers

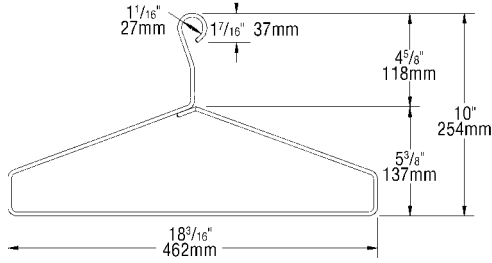

### Closed Loop Hangers

For 1" (25mm) diameter hanger rod.

Description	Model #
Closed loop hanger/chrome	CLH-C
Closed loop hanger/stainless	CLH-S
Closed loop hanger/electropolished	CLH-EP

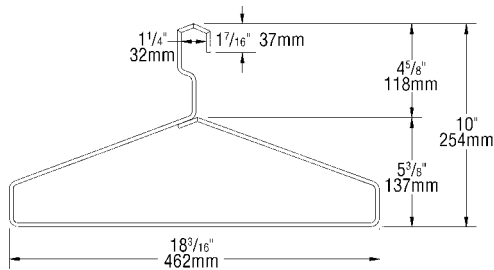

### Open Loop Hangers

Description	Model #
Open loop hanger/chrome	OLH-C
Open loop hanger/stainless	OLH-S
Open loop hanger/electropolished	OLH-EP

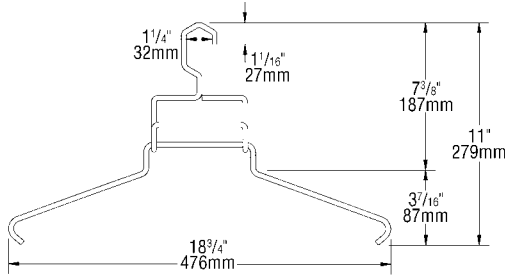

### 2-Piece Hangers

For use with non-removable hanger models. The top component is affixed to the gowning rack, while the bottom component is removable for convenient mounting of the garment. These hangers discourage removal from the gowning area.

Description	Model #
2-piece hanger/electropolished	TPH-EP
2-piece hanger/stainless	TPH-S

## Hanger Bar Kits

For use with 2-piece hangers and open loop hangers only. Retrofits existing shelving into freestanding or wall mounted gowning racks. End brackets clip onto underside of wire shelf. Hanger bar bolts onto end brackets. Hanger slots on standard 2 1/2" (64mm) centers. Other spacing available. Hangers not included. Hanger Bar Kit will mount only on 24" (610mm) wide shelves.

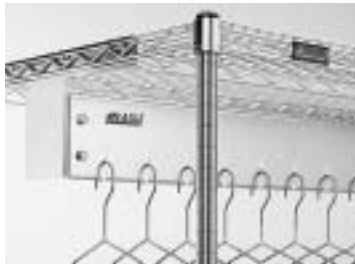

length	weight	number of	electropolished	stainless steel	chrome
in.	mm	hanger slots	model #	model #	model #
48"	1219	17	HBK-48EP	HBK-48S	HBK-48C
60"	1524	22	HBK-60EP	HBK-60S	HBK-60C
72"	1829	27	HBK-72EP	HBK-72S	HBK-72C

